



Anchor Tenants

Anchor Space Available
 CVS / Pharmacy
 Curves
 Subway

GLA: 121,383 SF

Contact Information

Charlie Owens
 Leasing Specialist
 Jones Lang LaSalle
 6805 Morrison Blvd, Suite 200
 Charlotte, NC 28211
 tel +1 704 804 5794
 fax +1 704 804 5751
 charlie.owens@am.jll.com

Center Highlights

- Tenant mix includes a freestanding bank, a drugstore, a cellular service provider, a health center, & Subway.
- I-57 Visibility.
- Located on a predominant retail arterial - Adjacent to new Super Wal-Mart.
- Visitors to the nearby recreational areas of Rend Lake and Benton Park drive additional traffic.
- Over half of the population are White Collar Workers.
- Adjacent to new Super Wal-Mart.

Demographics

	3 Mile	5 Mile	10 Mile
Population			
Current Year Population	8,473	11,874	33,781
Income			
Average HH Income	\$36,023	\$38,885	\$38,914
Median HH Income	\$27,287	\$29,102	\$29,536
Per Capita Income	\$16,746	\$18,100	\$18,105
Households			
Current Year Households	3,939	5,527	15,717
Median Age			
Median Age	41.1	41.1	40.3



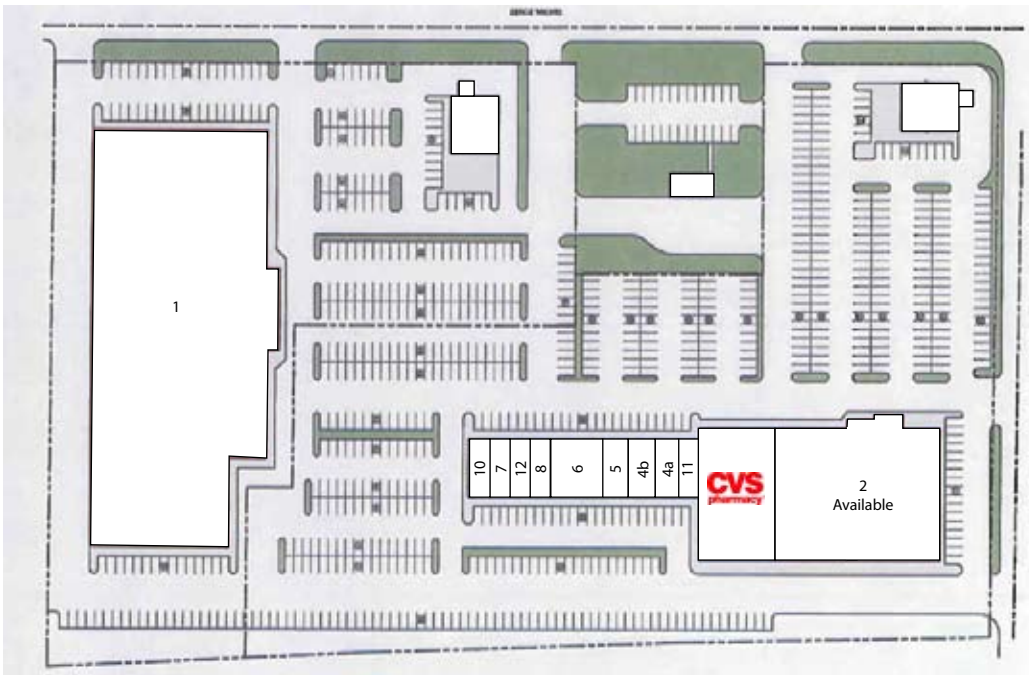

Tenant List 12/2008

Suite #	Tenant	SF
1	Rural King	72,813
2	Available	24,100
3	CVS Drugs #6372	10,070
5	Full Moon House	1,520
6	Available	3,600
7	Subway	1,200
8	Available	1,200
10	Magic Cash	1,200
11	Available	1,200
12	Verizon Wireless	1,200
4A	Curves of Benton	1,400
4B	Available	1,880

Total GLA 121,383

Rend Lake

