



Shoppes of Monroe

Monroe, GEORGIA

Anchor Tenant(s)

**Anytime Fitness
AT&T Wireless
SunTrust**

GLA: 23,500 SF

Center Highlights

- Located at the intersection of Highway 78/10 and Highway 138 in a growing area which expects to see a 15.9% increase in population over the next 5 years within 5 miles of the Shoppes of Monroe.
- This site is located across from the West Springs Office Park and future home of the Walton Regional Medical Center

Contact Information

Jenn Williams
Leasing Specialist
Jones Lang LaSalle
1125 Sanctuary Parkway, Suite 170
Alpharetta, GA 30009
tel +1 678 226 5280
fax +1 312 821 6660
jenn.williams@am.jll.com

Amanda Ethridge
Leasing Specialist
Jones Lang LaSalle
3424 Peachtree Road NE, Suite 400
Atlanta, Georgia 30326
tel +1 866 268 9164
fax +1 404 233 4763
amanda.ethridge@am.jll.com

Demographics

Population	3 Mile	5 Mile	10 Mile	3 Min.	5 Min.	10 Min.
Current Year Population	18,835	29,915	88,150	2,385	9,509	26,698
5 Year Projection	21,311	34,566	106,690	2,637	10,518	30,812
Population Growth Rate	13.14%	15.55%	21.03%	10.55%	10.62%	15.41%
Income						
Average HH Income	\$55,258	\$60,006	\$67,565	\$63,825	\$53,886	\$59,031
Median HH Income	\$42,542	\$47,457	\$57,271	\$48,793	\$39,796	\$46,411
Per Capita Income	\$20,266	\$21,849	\$23,574	\$23,135	\$20,895	\$21,446
Households						
Current Year Households	6,908	10,893	30,757	939	3,687	9,699
5 Year Projection	7,815	12,585	37,157	1,040	4,083	11,189
HH Growth Rate	13.13%	15.53%	20.81%	10.72%	10.73%	15.37%
Median Age	35	35	36	36	34	35



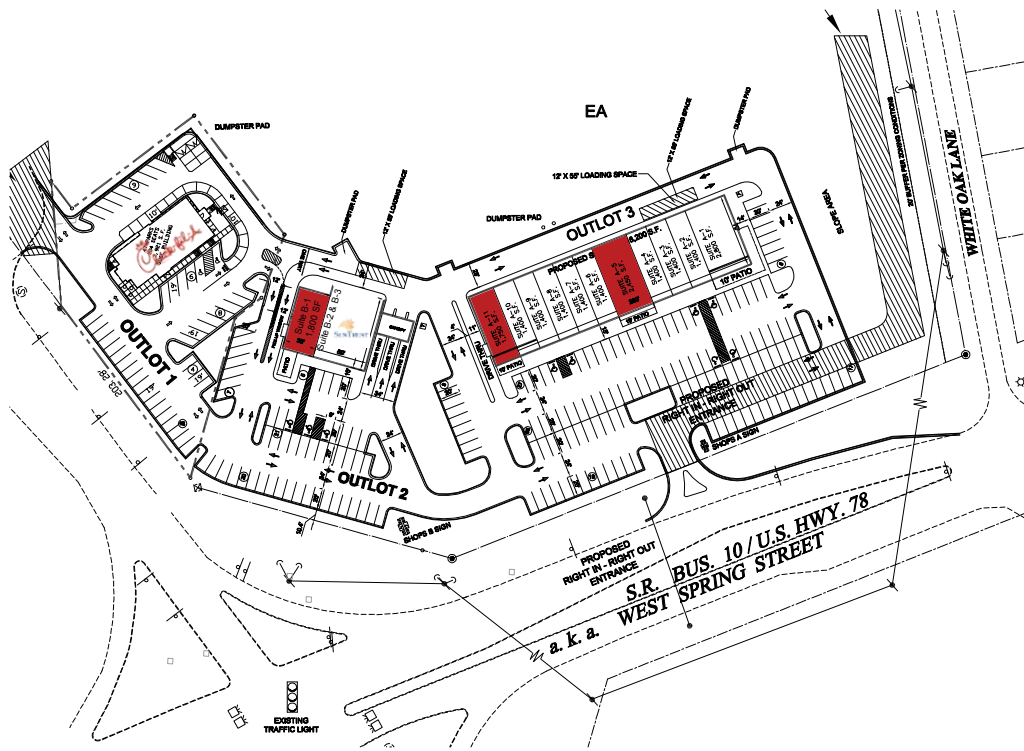

Tenant List 01/2010

Suite #	Tenant	SF
A1-3	Tokyo Japanese Sushi/Hibachi	5,600
A4	PrimeMobile (AT&T Wireless)	1,400
A5	Available	2,450
A6-9	Anytime Fitness	5,600
A10	Little Caesars	1,400
A11	Available	1,750
B1	Available	1,800
A11	Available	3,500
Total GLA		23,500

Shoppes of Monroe

