



**JONES LANG  
LASALLE®**

*Real value in a changing world*

**2600 W. Big Beaver, Troy  
For Lease**

**Up to 92,090 RSF Available**



**Building Features:**

*Michigan's Only LEED Gold EB Certified Facility*

- Cafeteria / Sundry Shop
- Attached Parking Deck
- Six-story Glass Atrium
- Full Floor Available
- Conference Center
- 24/7 Security

**Prime Location:**

- Located on the North side of Big Beaver Road, just West of Coolidge Highway
- Convenient access to I-75 and Woodward Avenue
- Building is adjacent to the Somerset Collection and minutes away from downtown Birmingham

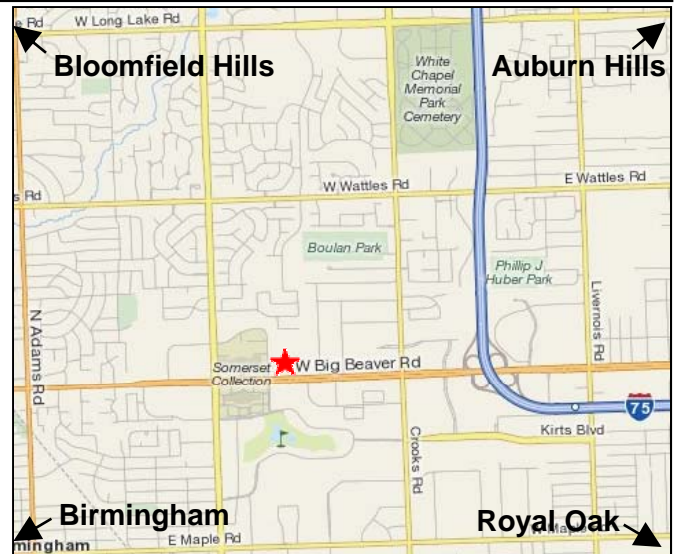

**For additional information call**

Ron Gantner

[Ron.Gantner@am.jll.com](mailto:Ron.Gantner@am.jll.com)

+1 313 961 6650

Jones Lang LaSalle Americas, Inc.

[www.us.joneslanglasalle.com/detroit](http://www.us.joneslanglasalle.com/detroit)

AJ Weiner

[AJ.Weiner@am.jll.com](mailto:AJ.Weiner@am.jll.com)

+1 313 967 4107

Jones Lang LaSalle Americas, Inc.

[www.us.joneslanglasalle.com/detroit](http://www.us.joneslanglasalle.com/detroit)



**JONES LANG  
LASALLE®**

*Real value in a changing world*

**2600 W. Big Beaver, Troy  
For Lease**

**Up to 92,090 RSF Available**

**Typical  
Floor Plan**

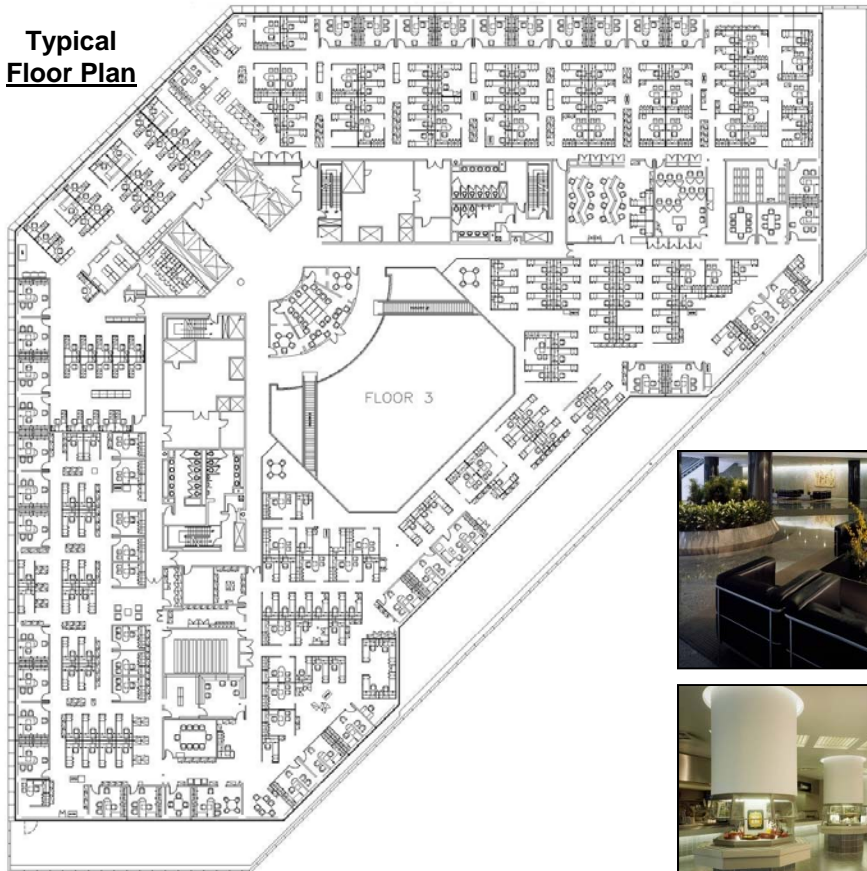

Current Vacancies	Rentable Sq. Ft.	Notes
1 <sup>st</sup> Floor (Partial)	Fully Leased	Entrance from Main Lobby
3 <sup>rd</sup> Floor	67,698	Full Floor Availability
4 <sup>th</sup> Floor (Partial)	6,216	Entrance at Elevator Lobby
5 <sup>th</sup> Floor (Partial)	5,726	Demiseable
Lower Level (Partial)	12,450	Raised Floor Office Space



**For additional information call**

Ron Gantner

[Ron.Gantner@am.jll.com](mailto:Ron.Gantner@am.jll.com)

+1 313 961 6650

Jones Lang LaSalle Americas, Inc.

[www.us.joneslanglasalle.com/detroit](http://www.us.joneslanglasalle.com/detroit)

AJ Weiner

[AJ.Weiner@am.jll.com](mailto:AJ.Weiner@am.jll.com)

+1 313 967 4107

Jones Lang LaSalle Americas, Inc.

[www.us.joneslanglasalle.com/detroit](http://www.us.joneslanglasalle.com/detroit)